

Club Beginnings

In September 1912, golfers living in Bonnybridge were thinking about starting a Golf Club in or near the village. On 23rd January 1913 a public meeting was held in the Reading Room of the public hall in Bonnybridge to discuss the subject. It was agreed to start a club and to arrange another meeting to elect office bearers. The lease of ground on Muirhead estate drove loan was to be considered. At a further meeting on 30th January, Office Bearers were elected. The committee was left to draw up a constitution and Rules for the club, which were to be submitted to a general meeting of the members. A 14 year lease was secured of the ground on the Muirhead estate, which was considered suitable for a 9 hole course. About 3 months later the golf club gave up the idea of leasing the field on Muirhead estate, and moves were being made to consider arrangements with another proprietor.

It was a little over seven years later, in August 1924 that the club finally found suitable ground for a 9 hole golf course. The new course was to be on the current site at Roughmote farm. On the 9th of December 1924 a Meeting was held in Lesser Public Hall, Bonnybridge, of all interested in forming a golf club in the village.

Motion –

- “That a golf club be formed in Bonnybridge”
- A portion of Dunipace Estate be leased from coal owners Messrs Robert Addie & Sons Ltd for a period of 25 years at an annual rent of £55.00

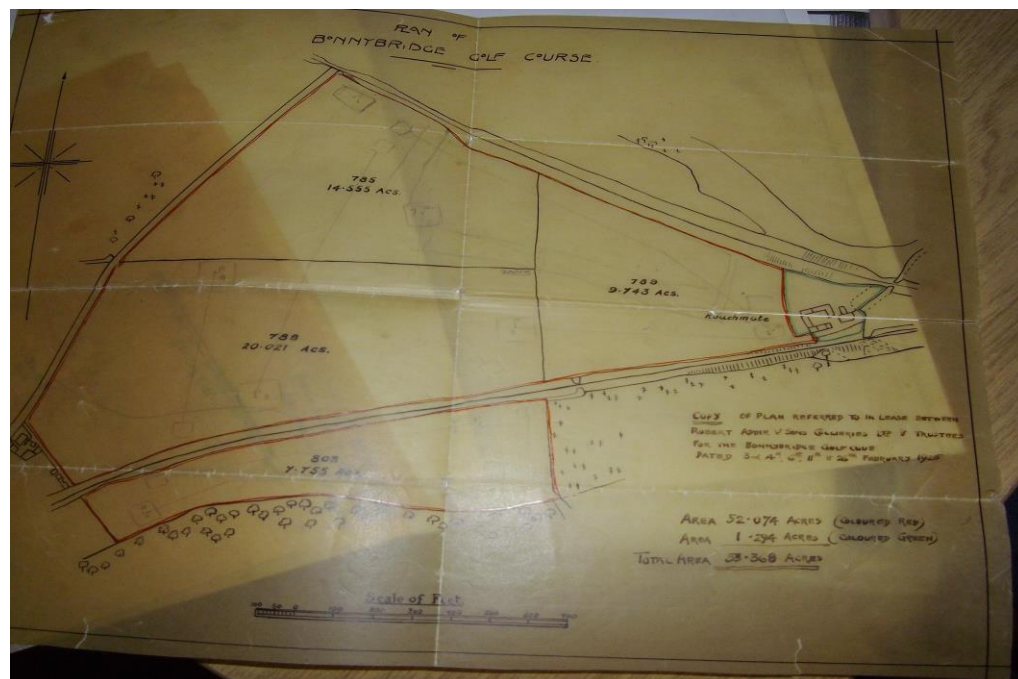

Original land leased from R Addie + Sons (Colliers)

A Committee was formed with the following duties:

- a) To decide initial running costs and decide on entry and subscription fees.
- b) Draw up a scheme for financing initial outlay in laying out ground, erecting a clubhouse and purchasing necessary equipment.
- c) To make arrangements for the playing of cricket and hockey.
- d) To publicise to all interested parties a general prospectus of the club.
- e) To draw up a constitution and rules proposal for the first general meeting . Mr R Bell appointed Chairman of Committee, Mr L A Rae appointed as Secretary.

■ **Meeting 11/12/1924**

- First meeting of General Committee

■ **Meeting 23/1/1925**

- Dr J Young was co-opted onto Committee and became first Captain
- Four schemes on how the club was to be set up were proposed, with scheme 3 being found to be the best option, Scheme 3 was to have 3 separate clubs i.e. Golf, cricket and hockey all sharing the clubhouse.
- Revised estimate of the initial expenditure to set up the club would be £1,149.00 equivalent to £51000 today
- A Report was received from Gordon Lockart (Professional Gleneagles) re the setting out and preferred layout of 9 holes
- Annual Subscriptions were recommended as follows:
- Gentlemen 31/6d (entry fee 10/6d)
- Ladies 30/1d (entry fee 7/6d)

Sub-Committees were formed and consisted of:

- a) Publicity Committee
- b) Green keepers Committee
- c) Course Committee
- d) House Construction Committee

By March 1925 the following was agreed:

- Local firms donated £100.00 in total and guaranteed any overdraft from Commercial Bank of Scotland
- Planning Permission for a Clubhouse had been granted. Messrs Spiers (Glasgow) was appointed building contractor (final bill for the clubhouse build was £769.00)
- Club to advertise for Tenant for grazing of sheep from May to November at fee of £10.00, to help maintain growth of fairway and rough, and bring in revenue.

Proposed byelaws were agreed :

- Two permanent Sub-Committees were set up:
- Handicap Committee
- Ladies Committee
- St Andrews rules of play were adopted
- Members were allowed one visitor per month.
- Ladies to have equal rights of play
- Junior members were permitted to maximum of 25
- A Cricket Club + Hockey club would be offered use of the grounds rent would be £15.00 from 18th April to 5th September.

50 applications were received for the Head Greenkeeper post .After interviews; Mr Hugh Shearer (Alexandria) was appointed Greenkeeper on a weekly wage of £2.00 per week. He commenced duties on Monday, 2nd March 1925 and the cost of moving his furniture to Bonnybridge was met by the Club. The greenkeeper was to be housed in Roughmute cottage next to the 2nd green. The committee then authorised the purchase of various items of greenkeeping machinery and associated tools:

- Horse Mower,
- Hand Mower and other course accessories including barrows, spades, etc.
- Two “reliable workmen” were hired to help the head Greenkeeper.
- A club Horse “Jean” to be housed at Home Farm when not on duty at course

7.	Repairs, Painting etc. to Greenkeeper's Cottage, as per A. Miller's estimate.	80: - : -
	<u>Laying out of Course</u>	
8.	Equipment - Mowers, Rollers. say - £130: -: - Additional Assistance to Greenkeeper for laying out course & hire of Horse. <u>70: -: -</u>	200: - : -

Total membership on opening day 1925 stood at:

- a. 114 Gents,
- b. 65 Ladies
- c. 13 Juveniles

Official opening day was set for 23rd May 1925

Opening day of the club was set for May 23rd 1925, new furnishings for the Clubhouse were agreed and the Green keepers wife, Mrs Shearer, provided “teas” at the Clubhouse for 1/- . non members paid 6d for entry.Copies of the club constitution and bye laws were posted in the clubhouse and the Opening ceremony was scheduled for 23rd May scheduled at 2.30 p.m., An exhibition game between Glasgow Professional Golfers J Sutherland (Baltimore) and W McMinn (Glasgow Golf Club) was to commence at 2.45 p.m. The Professional Golfers would be transported from Greenhill Station to the golfcourse and they would be paid £2.00 each to cover their expenses. Two caddies were provided, Mr Wilson, a committee member and Mr Shearer the greenkeeper. Sergeant Grant and Constable Somerville were requested to be in attendance and Black and white rosettes were supplied by Miss Cassels at the Toll for the stewards, The Captain and Secretary of Kilsyth, Falkirk Tryst ,Falkirk ,Denny and Polmont golf clubs were invited to the opening ceremony and Collier Brown (Falkirk) took photographs on the opening day. The opening ceremony was carried out by The Honorary President’s wife, Mrs George Albert Ure,and the weather on the day was rainy with a good turnout of people.

BONNYBRIDGE GOLF CLUB.

Opening of New Course and Pavilion

The district of Bonnybridge was last Saturday afternoon the scene of an interesting ceremony, the occasion being the opening of the new golf course of the recently-formed Bonnybridge Club. Unfortunately, the proceedings were not favoured by weather conditions of the most desirable nature, but, despite the cold wind and intermittent showers of rain, there was a large and representative assembly. The opening ceremony was gracefully performed by Mrs George Albert Ure, of Wheatlands, wife of the hon. vice-president of the club, and the initial play over the course was made by Messrs Sutherland and MacMinn, the Balmore and Glasgow professionals, who gave an interesting exhibition game.

THE NEW COURSE.

The new course is at present one of nine holes, but may later on be extended to comprise eighteen holes. Situated at Roughington on the estate of Dunipace, it promises to become one of the best inland courses in the country. The ground was secured last autumn, on a 25 years' lease, from Messrs Robert Addie and Sons, the Glasgow coalmasters. It covers a total area of 32 acres, the bulk of which is very old grass land. Described as of a fine sporting nature, the course is certain to prove a great boon to district golfers who previously had to journey considerable distances for a game. The club has a membership of 170. The ground also accommodates the Bonnybridge Cricket and Hockey Clubs, who share with the golfers an attractive and substantially built Speirsque pavilion.

THE OPENING CEREMONY.

Prior to the opening ceremony, the gathering was photographed in front of the pavilion by Mr J. C. Brown, Falkirk. Rain fell during the ceremony, which was presided over by Mr George Albert Ure, hon. president of the club. The chairman was supported by a large number of club officials, guests, and representatives of neighbouring clubs.

At the outset, the Chairman said he did not think there was anything he had been connected with in Bonnybridge that had given him greater satisfaction than to have been in some way associated with the acquirement of that ground for golf links for Bonnybridge and district. They had looked over that ground for many years and looked forward to it as a possible course. It was only now, however, or rather, within the last few months, owing to the kindly and generous way they were met by Messrs Addie and Sons, the proprietors, that they had been able to come to terms and acquire the ground, for a lease of twenty-five years for use as a golf course, or for any other purpose in connection with sport. The ground was in the hands of trustees for the club, but their duties were of a purely formal nature, and consisted of the working of the lease, etc., until the club was in good going working order. (Hear, hear.) That, he added, would not be long. (Applause.) Dr Young and himself, and, at the beginning, also Mr Paton, interviewed the proprietors of the ground. At first they had some disappointments, but when, eventually, the ground came into the hands of Messrs Addie and Sons, things worked out all right. (Applause.) He hoped the ground would long be reserved for the golf club for Bonnybridge and district. (Applause.) Undoubtedly, golf was a game that would prove a great benefit to Bonnybridge and district. He knew Dr Young had been looking forward to telling his patients, instead of sending them to the Riviera, to take a week off work and spend it on the Bonnybridge golf course. (Laughter and applause.) It was a very simple prescription and one of the most satisfactory the doctor could put his name to. (Applause.)

Concluding, the Chairman said that as soon as the club was formed, they started to work and were able to get the clubhouse they now saw, erected in a very short time. He thought that was very creditable to the committee who had the matter in hand. He had to ask Mrs Ure to formally declare the course and clubhouse open, and after that, Messrs Sutherland and MacMinn, of whom they had all heard, if not seen before, had kindly agreed to give an exhibition round. That would be interesting and valuable to golfers and would be golfers, all of whom lost nothing by watching two experts at the game. (Hear, hear.) He had pleasure in handing Mrs Ure the key of the new clubhouse and asking her to declare open the house and course. (Loud applause.)

Mrs Ure, who was cordially received, said she was very pleased to have the honour of opening that clubhouse. There was no game, she thought, that was so good for both young and old as golf. (Applause.) She hoped the course would be well made use of. She would advise all beginners to have some lessons at first, as she knew how that helped one. Ben Sayers had given her her first lesson, many years ago. She had great pleasure in declaring open the house and course. (Applause.)

Mrs Ure, amid loud and prolonged cheers, then fitted the key in the lock of the pavilion door and threw it open.

SOUVENIR OF THE OCCASION.

Dr Young, captain of the club, then spoke briefly, stating that for many years they, in Bonnybridge, had had an eye on that piece of ground, and he was of the opinion that if it was not already the finest, they could soon make it one of the best golf courses of nine holes in the interior of Scotland. (Applause.) There had been many willing helpers in the cause, but he would like to specially mention the name of Mr Wallace, of Callendar Park, who had done his very utmost for them, and whom they were very pleased to see present that day. (Loud applause.) The clubhouse was built by Messrs Speirs, Ltd., and they had fully expected one of their representatives to be present that afternoon. On behalf of Messrs Speirs, he had been asked to present to Mrs Ure a little memento of the occasion. The souvenir took the form of a little instrument which brewed the liquid that cheered but did not inebriate. (Laughter.) Dr Young then called for a hearty vote of thanks to the Chairman, and Mrs Ure, and handed to the latter, Messrs Speirs's gift, a beautiful solid silver teapot, suitably inscribed.

Mr Ure fittingly acknowledged the votes of thanks and the present to Mrs Ure. The weather had somewhat cleared by this time, and the bulk of the crowd remained on the course and went round with Messrs Sutherland and MacMinn.

Course Evolution

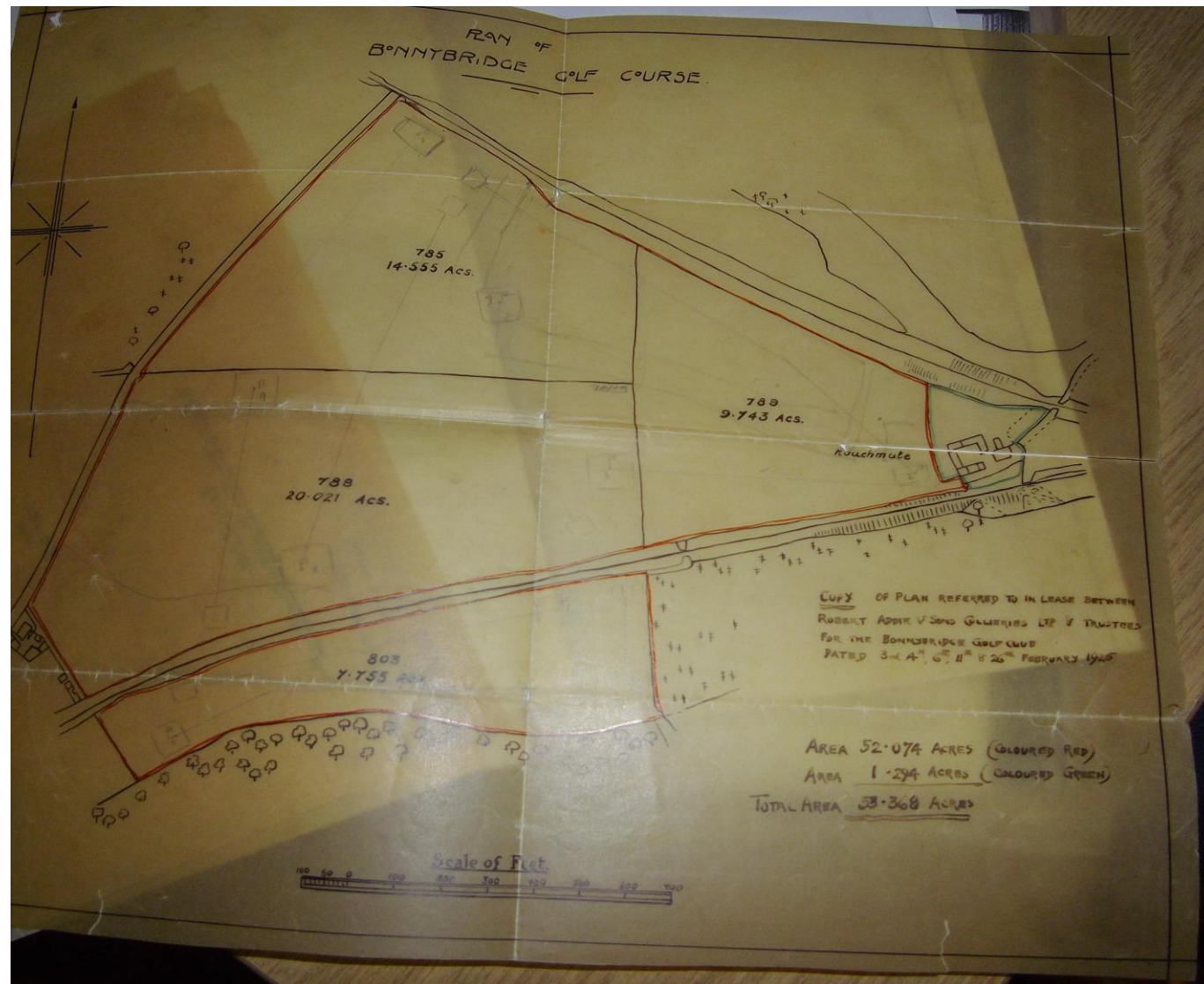

Original land leased from R Addie + Sons (Colliers)



Original land rented from R Addie transposed to present day

In 1925 a report was received from Gordon Lockart (Professional Gleneagles) re the setting out and preferred layout of 9 holes,fee £ 3 3/-The Course was measured in 1926 as below, and was further lengthened in the first year of existence by building new greens on 6 + 7, 40 yards further on, the course was re-measured and tee boxes first introduced with hole lengths inscribed in yards.

The course at the time was described as having “*the potential to be the best 9 holer in Scotland*” “*The land is of a Sandy substance a welcome difference from the normal inland course that turns into a quagmire during damp weather*” the official report stated. “*The land is surrounded to the South by a picturesque Scots pine wooded area. The Bonny bridge/Kilsyth railway dissects the course which also has various dykes running across several holes. The Denny/Falkirk railway line borders the course to the east*”

Original Holes

- 1st – 370 yards
- 2nd - 495 yards
- 3rd – 310 yards
- 4th – 105 yards
- 5th – 270 yards
- 6th – 305 yards
- 7th –275 yards
- 8th – 355 yards
- 9th – 220 yards

- Total 2705 yards

Present holes

- 1st
- 2nd
-
- 6th
- 7th
- 8th

Gordon Lockhart was Professional at Gleneagles in 1925 Born in Prestwick in 1887; he was a very successful amateur, winning the Irish Amateur Open in 1912, the Nairn Tournament of 1912 and the Arrol Trophy every year from 1909 to 1912 and again in 1920. He turned professional in 1921 and became the second pro at the Gleneagles club after David Adams from 1921 until, at least, 1938. He was runner-up in the Scottish Professional Championship many times in the 1920s. He also played in the pre-pre Ryder Cup on his home course in 1921 in which 12 players from Scotland and England played twelve from the USA as a preamble to the main business, the Thousand Guineas Golf Tournament, a match play event.

Original course layout transposed



Gordon Lockhart

Course Reconstruction

A decision was made to open a new course layout on Tuesday, 21st June 1938. The course was set out very similar to the present day without the medal tees at the 1st, 4th, 5th, 6th + 7th. The railway ran between the 8th hole and current practice strip. Part of the reconstruction was forming new greens at the 3rd, 4th, 5th and 9th. The new course length was 5784yds, par was deemed as 70, SS 71. The current practice strip did not exist and was part of farm land with grazing "coo's", a fence bordered the 9th fairway from the field. In 1962 the 4th + 5th Medal tees were added lengthening the course, and the PAR being duly updated to 72. It has stayed more or less this way since then.

To commemorate the newly reconstructed course A match was organised versus twelve top county players organised by Mr James Lindsay Jnr, county champion and Scottish Internationalist. Mr Lindsay's selection included many of the leading county players at the time:

K.G Patrick, T Dougall, J.C. Campbell, C Wyllie, R Rennie, W Main, James Lindsay, D A Buchanan, D Sommerville Jnr, G N Taylor, D Macewan Jnr and D J Mundie.

In 1949 D G Holmes held the course record of 68; this was beaten by Derek Riddell in 1984 shooting 66, and by Steven Hunter in 1989 with a 64 before Bryan White shot 63, currently the course record.

Summary of the course development over the years

- 1925 – Course developed with the help of G Lockart professional at Gleneagles
- 1938 – Course redesigned, similar to today's layout

.On the 3rd of February 1943 the committee received a letter from the Scottish Agricultural Committee requesting a cropping programme to be started in aid of the war effort. This involved the release of several acres of land to be released as farming land to grow crops. Between 1943 and 1952 the second hole was ploughed by a local farmer and potato seeds planted. The "wee field" was used for cattle grazing, the current practice area was also ploughed. In 1954 the 2nd hole was eventually restored and the club received £94:10:7d compensation from the government for reinstating the fairway, green and tee. 7 acres in total,

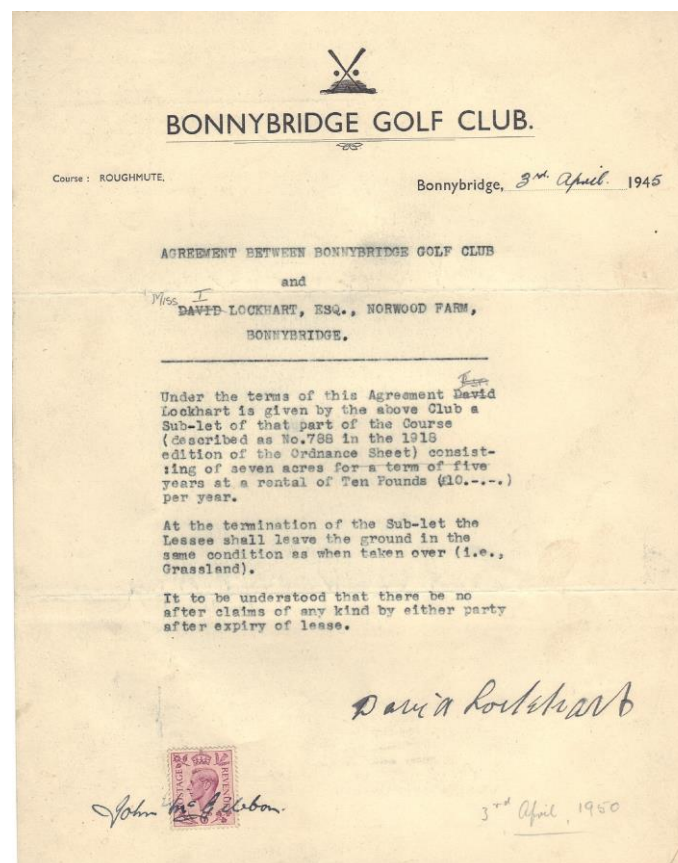

Agreement with D Lockart to plough 2nd fairway 1946

- In the late fifties the practice strip was formed
- In 1962 the 4th + 5th Medal tees were added lengthening the course, and the PAR being duly updated to 72.
- In 1969 the greens watering system was added to the course – previously a bowser had been used to drench the greens if required.
- 1975 - 1980 - Old railway line solum alongside 8th fairway that had been purchased in 1972 was filled in.
- 1993 – After years of flooded fairways the series of drainage ditches as seen today were set out

1st hole -“Road”

360yds Par 4



An original hole from the initial layout of the course, over the years two new tees were added in the 70s/80s and trees planted on the right and left hand side of the fairway, originally the only tree was the existing apple tree on the right hand side of the fairway. A stone dyke originally ran across the fairway approximately 30 yards from the tee, the dyke was removed in the 1930s

2nd Hole – Roughmute

485yds Par 5



Another of the original holes, the 2nd hole takes its name “Roughmute” from the land to the left of the hole, originally known as Roughmute farm. To the left of the 2nd green within the wooded area are the remains of Roughmute cottage and up until the 1960s, this area housed the greens equipment. Additions to the hole over the years are 3 fairway bunkers (now 2) to the right hand side of the fairway built in the 1980s and a further fairway bunker added in the 90s. Ditches were added as part of a drainage programme in the late 90s to remove accumulating surface water from the course. A new medal tee was built in 1980 to the left of the first green, but was subsequently removed due to health and safety concerns with errant tee shots' stone dyke originally ran across the fairway just over the first hill, this was removed in the 1930s. Between 1943 and 1953 the 2nd hole was ploughed up and potato's planted for the war effort.

3rd Hole – Hunters Folly 390yd Par 4



The 3rd hole is not an original hole and was part of the course redesign in 1938. The name Hunters Folly is taken from the wooded area in Chacefield wood which can be seen in the distance as the backdrop to the green.

Irrigation ditches were put in place again in the late 90s as part of the aforementioned drainage programme and the fairway backfilled and heightened within the dip over the first hill. Trees were planted as a wooded area to the left of the fairway in the 60s. In the 70s and 80s further trees were planted on either side of the fairway and behind the green. It still retains its stroke index one as the hardest hole on the course.

The original 3rd hole ran from the current 3rd teeing area across a dyke in the direction of the 5th green, to a green built just over the ditch in the current fifth fairway, the remnants of the green can still be seen and has been used in recent years as the 5th winter green, the dyke was removed in the 1930s.

4TH Hole – Rowan 195yd Par 3



The 4th hole is another hole built as part of the course redesign in 1938. The hole is called Rowan after an old Rowan tree to the left of the current green. Alas the original tree was taken down a few years ago following a disease and a new Rowan sapling replanted to continue the history.

The hole itself has undergone several changes over the years. Originally only 135 yards with one tee (current ladies tee) a medal tee was added in 1962 increasing the length of the hole to 195 yds and in the 1980s a third front tee was added. Ditches to the left of the hole were again added as during the 90s drainage programme due to significant surface water that gathered behind the 3rd green and on the 5th fairway.

Trees were planted to the right and behind the green in 1980 and the fir tree plantation to the left of the hole were originally planted as a nursery in the 1960s with a view to transplanting the young trees elsewhere on the course.

Original bunkers were greenside on the top right and bottom left of the green. The bunker on the left hand side of the green accumulated a lot of water and was filled in around 1980 and replaced with two small bunkers to the front left and right of the green. Subsequently the small bunker to the left was eventually filled in leaving the two bunkers on the right we see today. The original 4th hole is the present day 6th hole.

5th Hole – Towers 470yds Par5



The 5th hole is another hole built as part of the course redesign in 1938 with the original tee being the current ladies tee. In 1962 the medal tee was built lengthening the hole to a par 5. The ditches were again introduced in the 1990s as part of the drainage programme. Trees were introduced to the right hand side of the fairway and green in the 1980s. The practice area was originally in the current wooded area between the 3rd + 5th holes before being relocated to its current site in the 1960s. The current yellow tee was built in the 1980s along with another tee to the right of the existing tee, which was removed recently because of health and safety issues. The current fairway bunker from the tee was built in the 1980s and a kidney shaped greenside bunker to the left of the green was removed. A new greenside bunker was built several yards back from the left hand side of the green, this was subsequently filled in. The name of the hole “Towers” originates from two Cooling towers at nearby Bonnybridge power station which could be seen in the background of the hole before being demolished in the 1970s/80s. The original 5th hole was the current 7th hole.

6th Hole – Wee Pap 120yds Par 3



The start of what is affectionately known as the “wee field”. Known as the signature hole, the green has six greenside bunkers surrounding a sloping right to left green, and originally the hole was surrounded by a Caledonian pine forest until quarrying took place in the 1960s. Originally a pathway took you under the Bonnybridge to Falkirk/Denny railway line via the current parapet and the only teeing area was the current ladies tee. In 1926 the committee had to place a notice board next to the railway line to stop golfers taking a short cut over the line. As time moved on and the railway became abandoned a medal teeing area was perched on the railway embankment in the vicinity of the current 6th medal tee, the teeing area was protected by a rubber mat. In 1972 the club purchased the now abandoned railway lie and in the late 70s filled the ditch in along the 8th hole. In later years the embankment at the 6th teeing area was cut in half and the current medal tees formed, at the same time a new tee (now no longer used) was developed to the left of the 8th green. The original 6th hole was the current 8th hole.

7th hole – Bonnywood 310yds Par 4



Originally surrounded on the left by a Caledonian pine Forest before quarrying took place in the 1960s, the 7th hole was the original 5th hole, Bonnywood named after the local farm and area. Over the years several new tees have been built culminating in the most recent tee, the new medal tee. Several trees have been added to the right hand side of the fairway in recent years and to the back of the green. The most significant changes to this hole over the years was first of all the removal of two fairway bunkers set in the hill up to the green on the right and left hand side of the hill, and secondly the filling in of the railway embankment to the left of the 8th hole. In days gone by any drive from the 7th leaked right would end up down in disused railway with no shot, and as if to make it harder, for a period in the 1970s out of bounds was introduced along this stretch. The original 7th hole ran from the current 9th tee (the original tee can still be seen and is sometimes used as the 6th winter tee) to a green just behind the 4th ladies tee, the fairway passed through a stone dyke removed in the 1930s.

8th hole – Old Railway 300yds Par4



The 8th hole was the original 6th hole before the course revamp. Until 1980 a disused railway ran along the left hand side of the fairway with a steep embankment of around 20ft covered in rough and gorse, this made the tee shot very demanding. In 1980 during the M876 upgrade, the spoil from the new motorway construction was used to infill the railway and trees planted eventually by the forestry commission. Around 1979 attempts were made to lengthen the hole by moving the tee back to where the Nissan hut sits on the practice area and a new green was constructed to the left of the current green. Again health and safety prevented the use of the tee because of any wayward tee shots blindly landing on the 7th fairway and so the new hole was abandoned, the newly constructed green however is still utilised as the winter green. The original 8th hole ran from around the 4th ladies tee to green in the middle of the 9th fairway, the fairway passed through a stone dyke removed in the 1930s

9th Hole – Norwood 400yds Par 4



The 9th hole called Norwood after the area and cottage which once stood on the outskirts of the course was part of the redesign in 1938. In the 1960s a nursery of Fir trees were planted on the right hand side of the fairway, with a view to transplant on the course, they form a wooded area today. In the 1980s the Scottish woodland trust planted Rowan trees on the right hand side of the fairway and a selection of trees on the left hand side. The 9th fairway is separated from the practice area with a row of trees planted in the 1970s. Originally the practice area was a field which was owned and rented out by the club to a local farmer, a fence separated the field from the course. The original 9th hole ran from a teeing area around the Hawthorn tree in the middle of the 9th fairway to the area of the current practice putting green.

Greenkeeping at Bonnybridge over the years

50 applications were received for the original Head Greenkeeper post .After interview; Mr Hugh Shearer (Alexandria) was appointed Greenkeeper on a weekly wage of £2.00 per week. He commenced duties on Monday, 2nd March 1925 and the cost of moving his furniture to Bonnybridge was met by the Club. The greenkeeper was housed in Roughmute cottage sited in the area to the left of the current 2nd green, the cottage being extensively renovated by the local joiner Mr Menzies. Roughmute cottage remained the greekeepers abode until the golf club lease renewal in 1950 – whereby the club decided not to rent the area of Roughmute to cut down on expenditure. The club did however retain the use of a stable area and outbuilding to house greens machinery, a room for the greenkeepers was created at this point within the clubhouse. This lasted until 1968 when a bad storm and gale force winds badly damaged the roofs of the buildings at Roughmute rendering them of no use. In 1969 the club obtained a grant from the government to build a new greens shed on the existing practice strip at a cost of £550, at the same time a greens watering system was put in place. The greens shed stood until 1980 when it was replaced by the Nissan shed currently seen on the west side of the practice area. In 2013 a new modern and fully equipped greenkeepers shed was built at a cost of £2500.

Currently the greens equipment consist of a brand new triple greens machine, tractor, Cushman utility machine and fairway mower amongst other equipment ,along with our three greens staff ,a far cry from the original items of greenkeeping machinery, manning and associated tools which included:

1. Horse Mower,
2. Hand Mower, barrows, spades, etc.
3. Two “reliable workmen” who were hired to help the head Greenkeeper.
4. A club Horse “Jean” to be housed at Home Farm when not on duty at course

Club Shop

During the first 30 years of the clubs existence several professional golfers were in place at the club

In those days most greenkeepers doubled up as professionals providing lessons to new members for a fee and selling golf balls, often second hand.

In December 1959 the committee recommended purchasing a shed from Smith and Wellstood to accommodate the greenkeeper /professional which could also double as a shop. The shed which was a disused ambulance shed sited in The Chattan foundry was purchased for £5 and transported and erected facing the clubhouse (present site of old 1st medal tee) by the committee. The shed was eventually relocated in 1972 when the new 1st medal tee was built to the east side of the clubhouse., until it was no longer used and removed around 1990,

In 1961 Mr Dunsmore proffesional/greenkeeper resigned and the shop was leased to Mr Alex Mitchell for £5 per year. Mr Mitchell a local Bonnybridge man and ex champion ran the shop selling equipment and providing lessons until 1963 when he took up a post as club professional at Hoylake, leaving as the last club proffessional. Alex, s mother Mrs Mitchell ran the shop until 1976 when she retired, the shop being ran by Mrs Colquhoun , Mrs Skene and Mrs Munn. The shop/hut was eventually done away around 1990 when it was relocated to its present site currently ran by Mr T McDonald.

Bonnybridge Golf club clubhouse

- 1925 - Original clubhouse built by Speirs of Glasgow – cost £729 contained a large general room, a room each for home and visiting cricketers, a gent’s golfer’s room and a ladies room, and a well fitted kitchen and lavatory accommodation. Lighting was 1x paraffin lamp and 5 wall lamps.



INITIAL EXPENDITURE.			
ITEM	2.	3.	4.
1. Clubhouse, as per Speirs Ltd. Design 9545A. Exclusive of Foundations, Drains, Cold Water Supply, Lighting, Lockers, Stoves, Rhones & Down Pipes:	462:	-	-
2. Extra for Foundations, Drains, Sanitary Fittings, Urinal & Cold Water Supply, Rhones and Down pipes, taken at Speirs Ltd.'s estimate.....	165:	-	-
3. Extra for Grey Asbestos Cement Slates on Roof. ...	27:	-	-
4. Extra for Lighting & Stoves. (approximate) ...	20:	-	-
5. Drainage System on Septic Tank Principle, as suggested by Sanitary Authorities (Approximate): Also Gate and Gateway to be formed.	70:	-	-
6. Furnishing of Clubhouse: Table, Chairs, and possible provision for some Lockers. ...	25:	-	-
Clubhouse - Complete....	2769:	-	-
7. Repairs, Painting etc. to Greenkeeper's Cottage, as per A. Miller's estimate. ...	80:	-	-
<u>Laying out of Course</u>			
8. Equipment - Mowers, Rollers. say - £130: -:- Additional Assistance to Greenkeeper for laying out course & hire of Horse. ...	70:	-	-
	200:	-	-
9. Contingencies....	100:	-	-
	GRAND TOTAL.	£ 1149:	-

NOTE - By employing Local Contractors there may be some saving on items 2 & 5. This could be applied to the erection of a small lean-to kitchen behind Ladies' room with a sink etc. and stove to boil tea.

-----000-----

- 1925 – An extra 20 lockers were introduced due to the high demand.
- 1956 – New Gas lights fitted in clubhouse.
- 1956 - Repair bills were increasing for clubhouse including roof repairs etc – all repairs were carried out.
- 1956 – Enquired to Denny Golf club to purchase Denny golf club clubhouse, due to repairs carried out on own clubhouse it was decided not to proceed , instead the club purchased lockers from Denny golf club.
- 1956/57 – New lean – to, fitted to east side of clubhouse to house caddy cars.
- 1958 – Club offered Norwood cottage and 1 acre of land for £1500 - declined

- 1964 - Resolution to alter Club Constitution to allow sale of refreshments complying with the Licensing (Scotland) Act 1962 + License granted for Clubhouse for selling of excisable liquor
- 1965 – Kitchen area was turned into the bar and the greenkeeper in his spare time would cover the bar.
- 1965 - Trial opening hours for the bar would be: Saturday 11.00 a.m. – 2.30 p.m. 5pm – 7pm + Sunday 12.30 p.m. – 2.30 p.m.
- 1965 – First “one arm bandit” in place.
- 1965 – New clubhouse furniture bought, Burglar alarm fitted + 1965 – First “one arm bandit” in place.
- 1965 – Electricity put into clubhouse. (Electricity cost £90 per annum)
- 1969 – Existing locker rooms removed and main lounge size increased along with bar area – extension built onto the east of the clubhouse to house a new gent’s locker room. (Current green keepers “howf”), new sewage and water pipework were put in place. – levy of £10 per member over 5 years.



- 1970 – New Barrel store added to existing clubhouse – cost £325 (current secretaries office)
- 1974 – Extension built to the west of the existing clubhouse with new function hall including ladies and gents toilets. – cost £15000, McPherson tartan carpet fitted with Barbados blue chairs!
- 1977 – Tarmac surface to carpark – cost £2835
- 1980 - Fleming builders extended clubhouse to house new ladies and gents locker rooms with toilet and showering facilities along with new bar area and members lounge (current) cost - £43,900 – levy proposed at £30 per member.

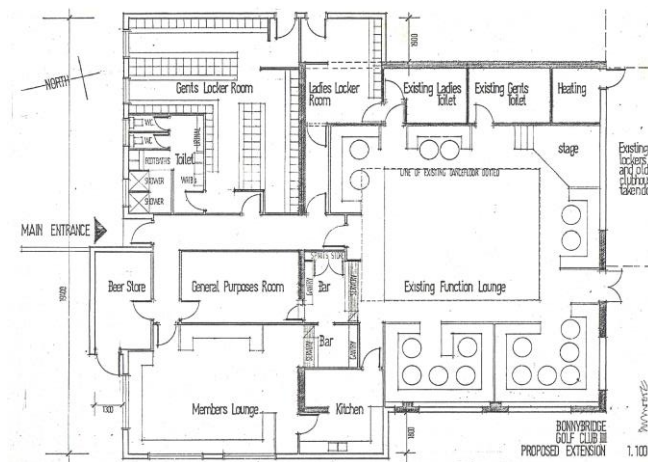

- 1984 – Gas central heating fitted to clubhouse
- 1988 – Old clubhouse wooden façade rough casted.
- 1993 – Car park relayed – cost £6900
- 1995 - The main lounge was refurbished at a cost of £35,462 - financed by a loan from the brewers
- 2011 – Gents showers removed and disabled facilities added + Main clubhouse roof replaced – cost £7000. – Brewers loan paid off.



clubhouse

Shop 1970 at 1st tee (Medal)



Shop 1980 east of